

SAFETY INSTRUCTIONS

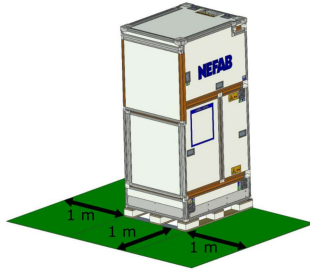

One person needed
Safety shoes needed
No tools needed

SAFETY INSTRUCTIONS



Needed space:
1.0 m behind
1.0 m on both sides

SAFETY INSTRUCTIONS

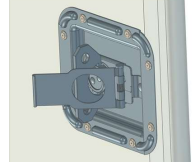

Fully fold back opened latches

SAFETY INSTRUCTIONS

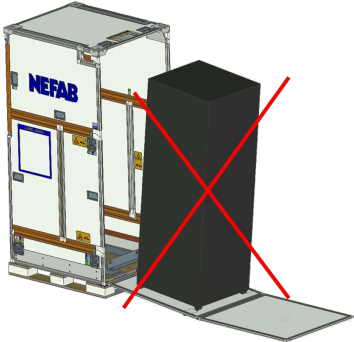

Never use front door as ramp!

SAFETY INSTRUCTIONS

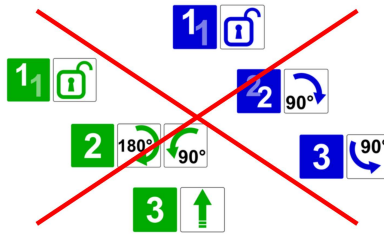

For hatch operation,
disregard labels.

HATCH OPERATION STEP 1

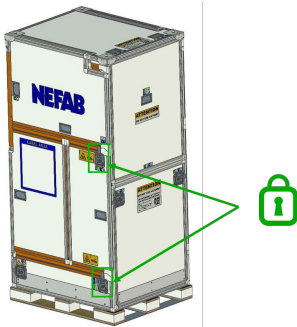

Verify that all four front latches are closed

HATCH OPERATION STEP 1

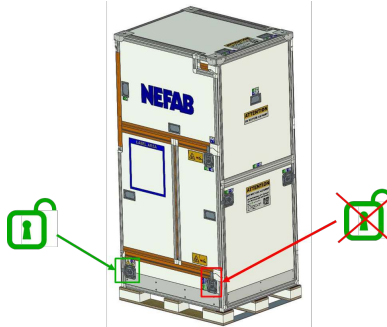

Open the lower rear latches. Do *not* open the lower front latches!

HATCH OPERATION STEP 1

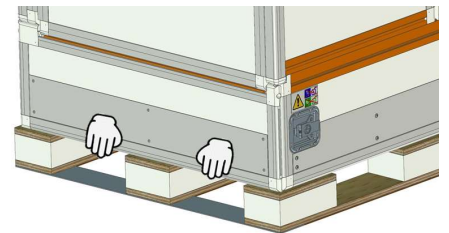

Swing hatch upwards and hold in place

HATCH OPERATION STEP 4

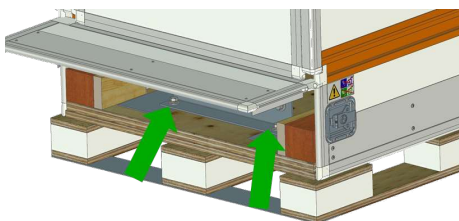

A second person can now access the mounting bracket.